

1:28
SCALE



MPO-2 MULTI-PURPOSE OCTOCOPTER: CARGO TRANSPORTER



HEY, STAR!

- KEEP AND FOLLOW THIS MANUAL EACH TIME YOU'D LIKE TO BUILD THIS MODEL.
- PROJECT 3D PRINTING TIME: 20H; BUILD TIME: 5H. TIMES ARE ESTIMATED AND WILL VARY BASED ON YOUR PRINTER SETUP AND YOUR SKILL LEVEL.
- MINIMUM BUILD VOLUME 11×6×6" [28×15×15 CM] USING 0.4MM NOZZLE.
- USE CAUTION WHEN GLUING. ENVIRONMENT SHOULD BE CLEAN AND WELL-VENTILATED.
- IN A GROUP/CLASSROOM ENVIRONMENT IT'S BEST TO HAVE SEVERAL 3D PRINTERS OPERATING AT THE SAME TIME; THIS WAY PRINTS TAKE QUICKER TO PRINT. PRE-LOAD EACH PRINTER WITH THE RECOMMENDED FILAMENT COLOR (SEE "FILAMENT COLORS").
- SHARE A PHOTO OF YOUR CREATION AND DON'T FORGET TO TAG IT #3DPRINTINGSTAR.



THIS PRODUCT IS LICENSED TO ITS ORIGINAL PURCHASER AND IS NOT TO BE RESOLD WITHOUT WRITTEN CONSENT FROM 3D PRINTING STAR. LEARN MORE ABOUT [LICENSING \(3DPRINTINGSTAR.COM/LICENSE\)](https://www.3dprintingstar.com/license) AND GROUP LICENSING (GREAT FOR SCHOOLS). [CONTACT US \(3DPRINTINGSTAR.COM/CONTACT\)](https://www.3dprintingstar.com/contact) WITH ANY QUESTIONS. PLEASE USE AT YOUR OWN RISK.



VISIT [WWW.3DPRINTINGSTAR.COM](https://www.3dprintingstar.com) FOR LATEST VERSION OF MANUAL AND FILES.

INSTRUCTION MANUAL MAY CHANGE WITHOUT NOTICE. MANUAL RELEASE DATE: 9/11/2021. MANUAL VERSION: 1.0.

CONTENTS

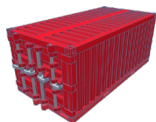

SMALL CONTAINER
PAGES 4-13

13:37
PRINT TIME

2H
BUILD TIME

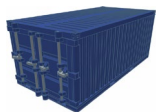

LARGE CONTAINER
PAGES 14-23

3-10H
PRINT TIME

2H
BUILD TIME



MPO-2 OCTOCOPTER
PAGES 24-40

6-20H
PRINT TIME

8-10H
BUILD TIME



MPO-2 FILAMENT COLORS (10)



BLUE

RED

CONSTRUCTION
YELLOW

BLACK

BLACK
FLEXIBLE

SILVER

WHITE

DARK
BROWN

LIGHT
WOOD

GLOW-IN-
THE-DARK

ORDER ONLINE: [3DPRINTINGSTAR.COM/MPO-2](https://3dprintingstar.com/mpo-2)

TOOLS AND SUPPLIES



3D PRINTER
150~120



CA GLUE



MAGNETS
~24



SPRINGS
~3



HOBBY KNIFE



CLIPPERS



SAND PAPER
180 GRIT

ORDER ONLINE: [3DPRINTINGSTAR.COM/SUPPLIES](https://3dprintingstar.com/supplies)

APPS

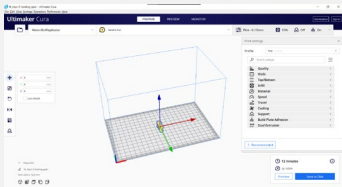

CURA IS A FREE SLICER BY ULTIMAKER. USE IT TO GENERATE PRINT-READY FILES FOR YOUR 3D PRINTER.

[ULTIMAKER.COM/SOFTWARE/ULTIMAKER-CURA](https://ultimaker.com/software/ultimaker-cura)



TINKERCAD IS A FREE 3D DESIGN APP BY AUTODESK. USE IT TO CREATE AND EDIT 3D MODELS FOR 3D PRINTING.

[TINKERCAD.COM](https://tinkercad.com)

SMALL CONTAINER

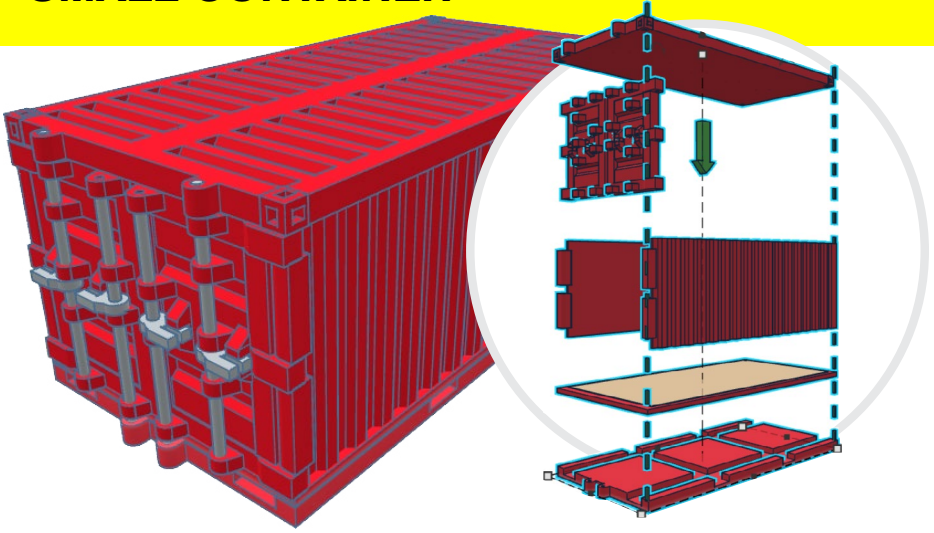

FILAMENT COLORS



RED

LIGHT
WOOD

SILVER

TOOLS & SUPPLIES



CA GLUE

MAGNETS
×5

CLIPPERS

1



CONTAINER-SM-BASE-A.STL

164.76×80×5MM

2H 46M

32G



2



CONTAINER-SM-BASE-B.STL*

160×80×2.5MM

2H 29M

29G

*MULTI-COLOR PRINT; PAUSE PRINTER AND CHANGE TO WOODEN FILAMENT TO FINISH PRINTING TOP PART OF THE BASE.



3



A

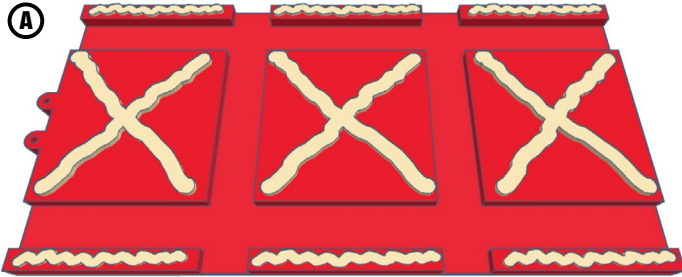

B

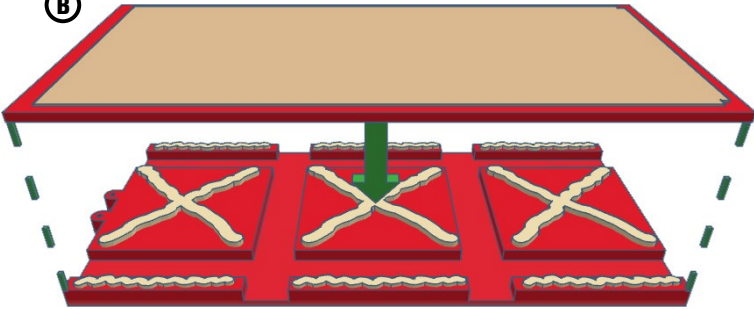

4



CONTAINER-SM-WALLS.STL

160×80×54.5MM

4H 32M

38G

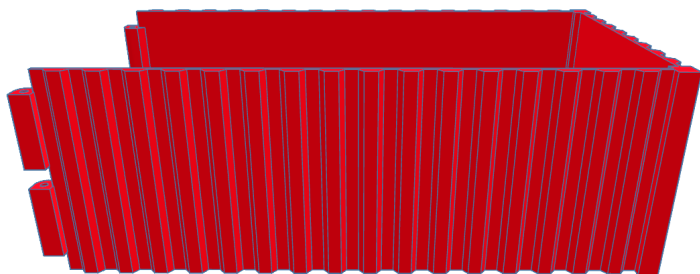

5

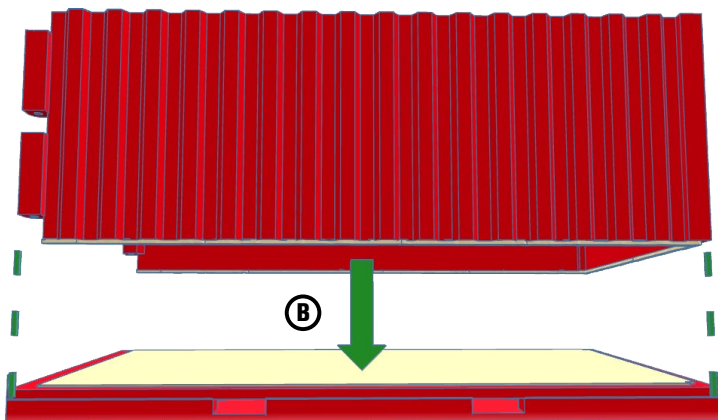
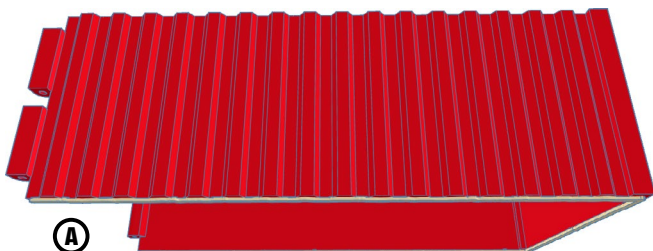

6



CONTAINER-SM-DOORS.STL

82.5×54.25×9.76MM

1H 18M

13G

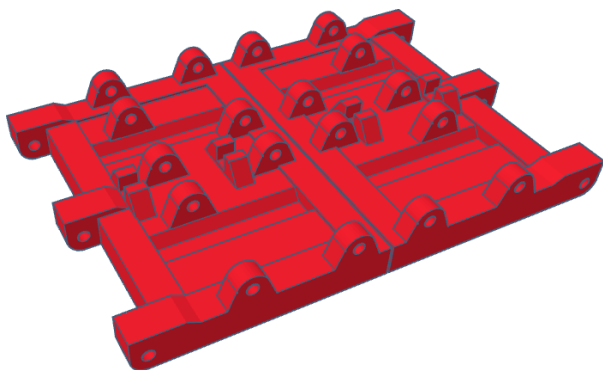

7

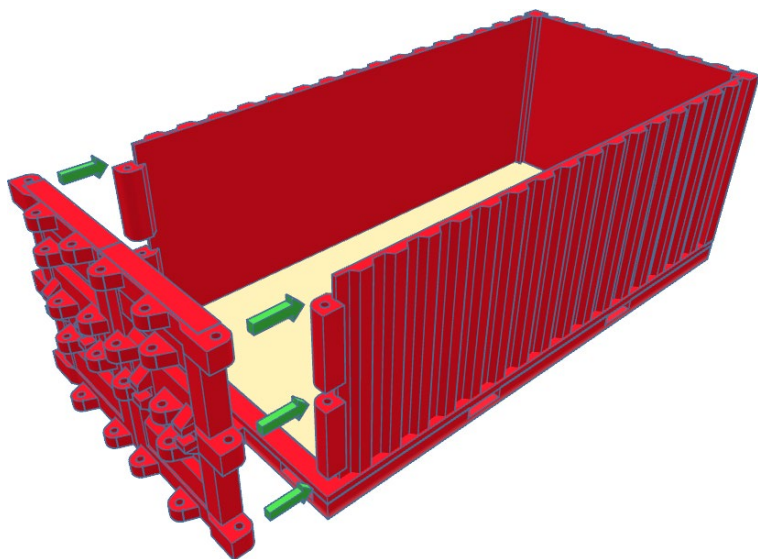

8



DOOR HINGE PINS

CUT TWO EQUAL 54MM PIECES OF SILVER FILAMENT USING CLIPPERS AND GENTLY STRAIGHTEN THEM OUT BY HAND.



A



×2 54MM (ACTUAL SIZE)

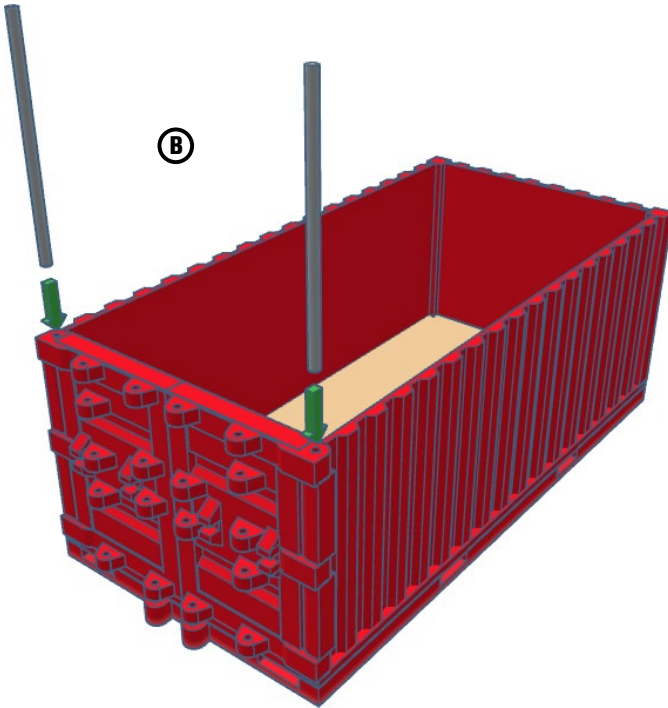

B

9



*5

CONTAINER-SM-ROOF.STL

165×80.5×5.25MM

3H 8M

36G

CONTAINERS ARE MAGNETICALLY ATTACHED TO OCTOCOPTER. PAUSE THE PRINTER AND PLACE MAGNETS INTO MAGNET ENCLOSURES BEFORE FINISHING THE ROOF PRINT.

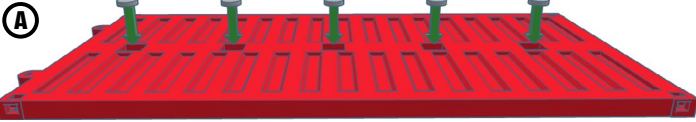

10



TO PREVENT DOORS FROM BEING GLUED IN-PLACE, BE SURE TO ONLY DEPOSIT GLUE ON THE WALLS OF THE CONTAINER, AVOIDING THE HINGES.

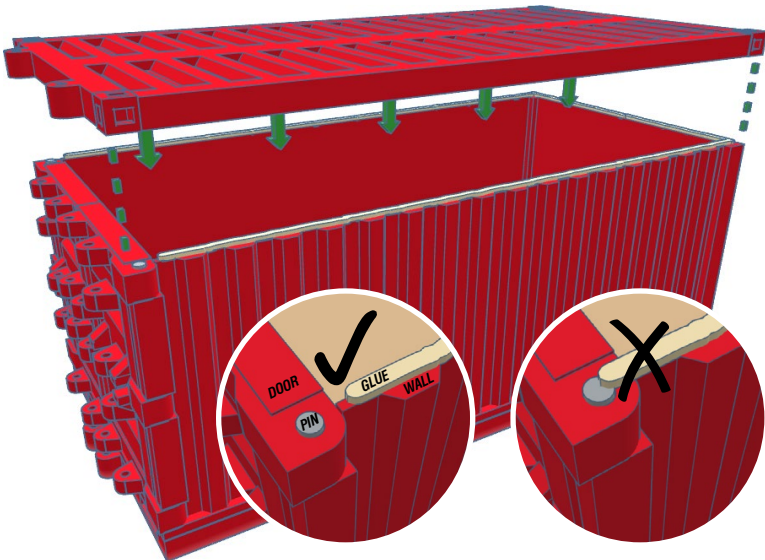

11



CONTAINER-SM-DOOR-LOCKS.STL

56.25×6×2MM

4M

0.25G



(A)

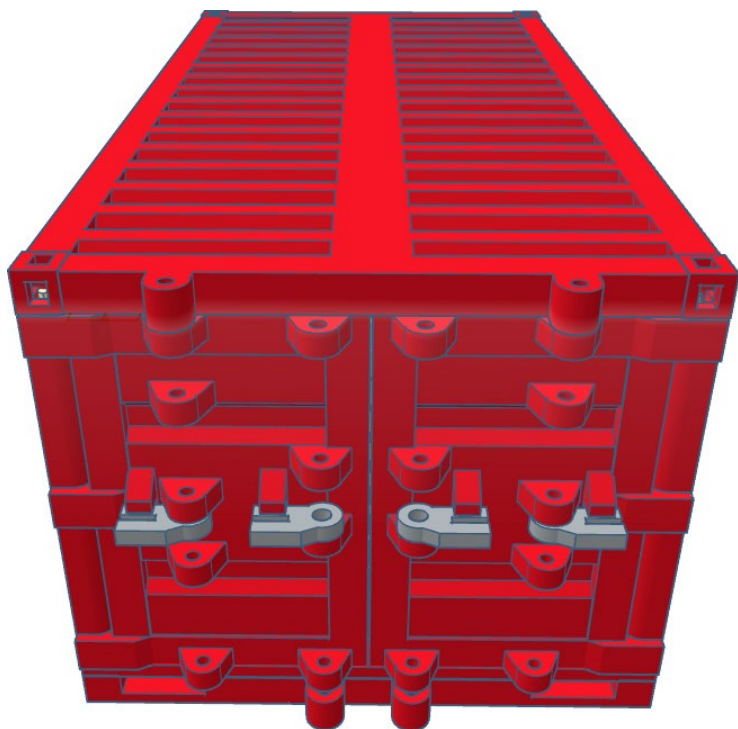

(B)



12



DOOR LOCK PINS

CUT FOUR EQUAL 59MM PIECES OF SILVER FILAMENT USING CLIPPERS AND STRAIGHTEN THEM OUT BY HAND.

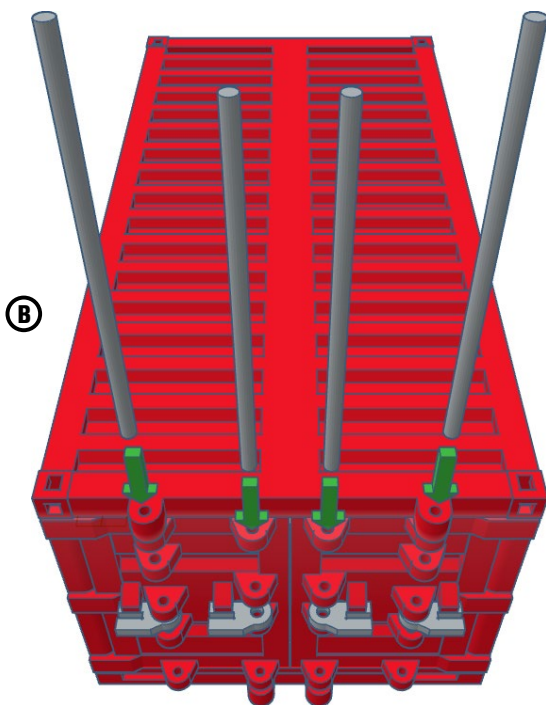
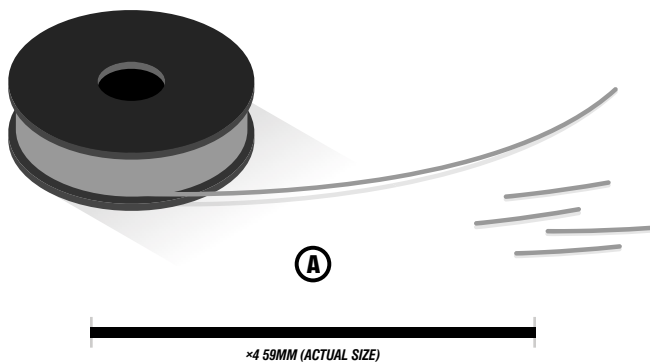

13



TAKE EXTRA CARE WHILE GLUING LOCK HANDLES TO LOCK PINS. ENSURE THAT THE PIN DOES NOT GET GLUED TO THE DOOR. USE ONLY A TINY DROP OF GLUE ON EACH HANDLE AS SHOWN BELOW.

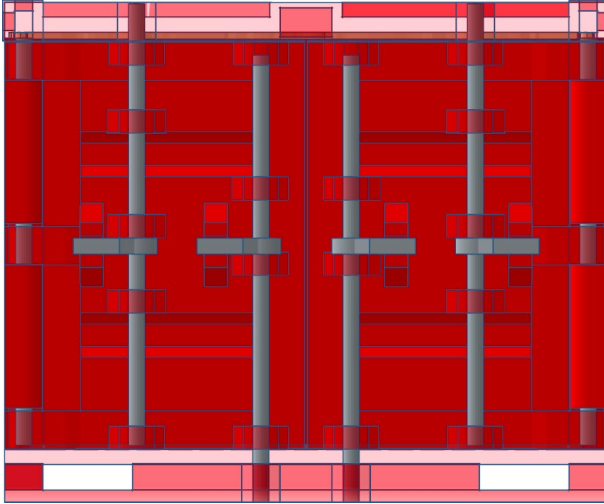

POSITION OF LOCK PINS

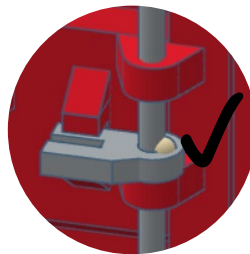

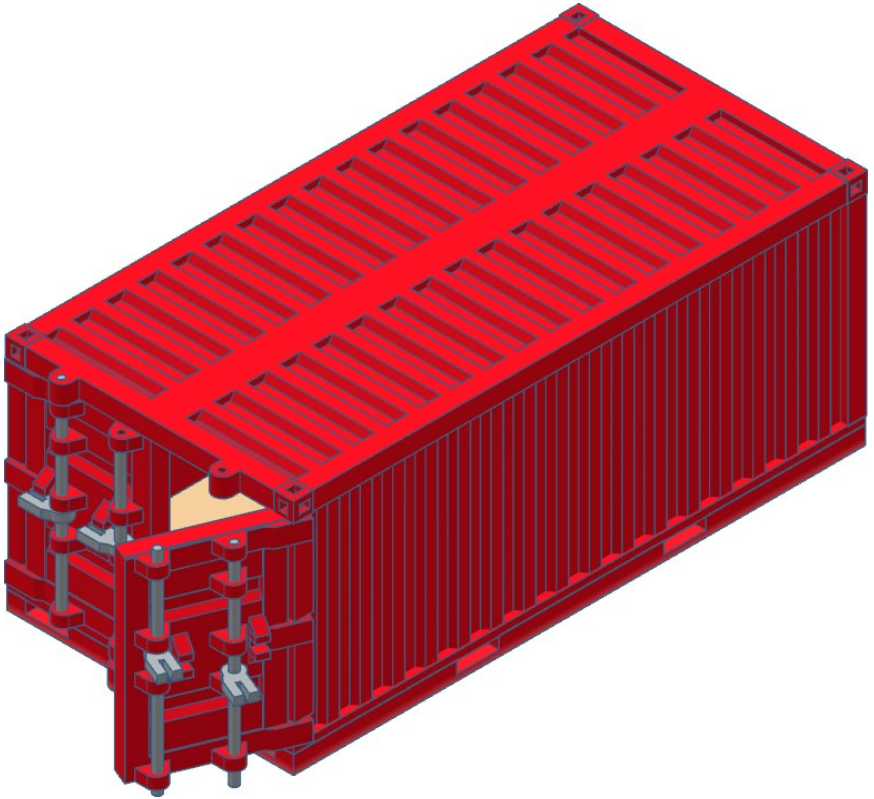

LARGE CONTAINER



FILAMENT COLORS



BLUE

LIGHT
WOOD

SILVER

TOOLS & SUPPLIES



CA GLUE

MAGNETS
×5

CLIPPERS

1



CONTAINER-LG-BASE-A.STL

164.76×80×5MM

2H 46M

32G



2



CONTAINER-LG-BASE-B.STL*

160×80×2.5MM

2H 29M

29G

*MULTI-COLOR PRINT; PAUSE PRINTER AND CHANGE TO WOODEN FILAMENT TO FINISH PRINTING TOP PART OF THE BASE.



3



A

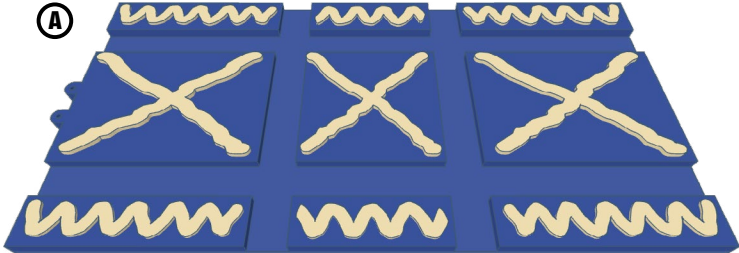

B

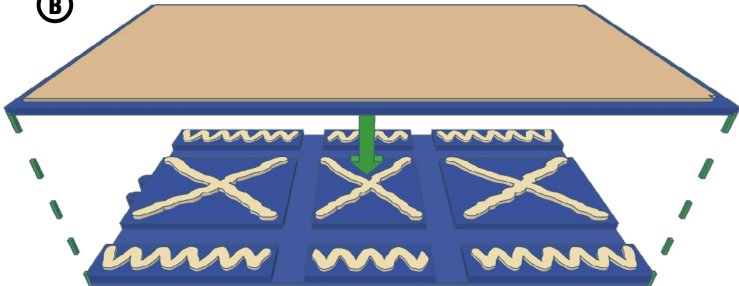

4



CONTAINER-LG-WALLS.STL

160×80×54.5MM

4H 32M

38G

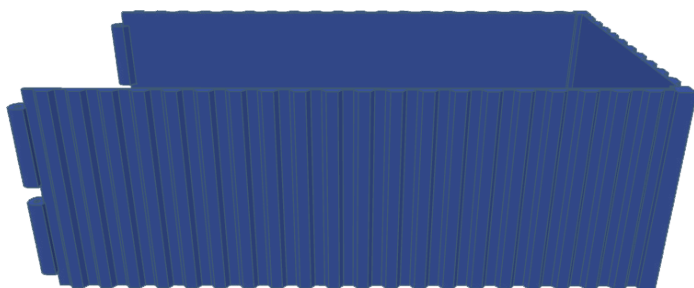

5

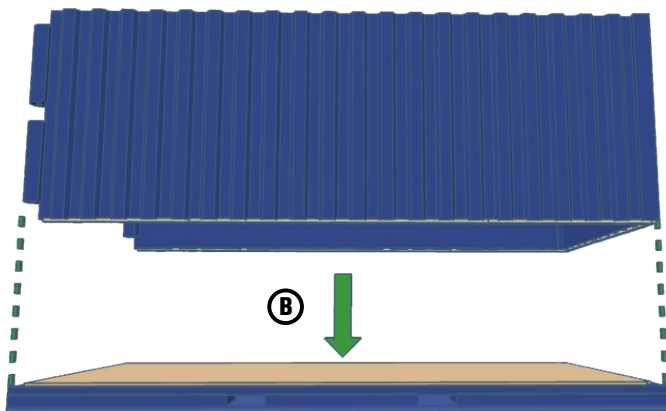
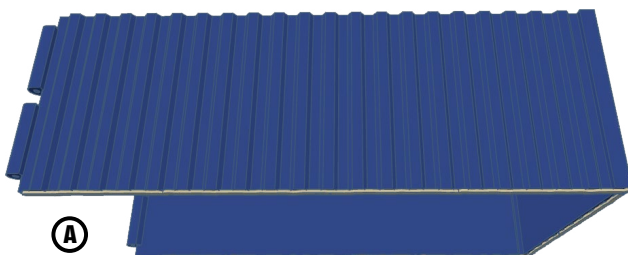

6



CONTAINER-LG-DOORS.STL

82.5×54.25×9.76MM

1H 18M

13G

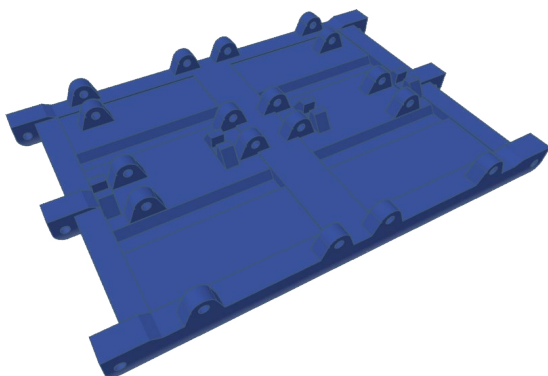

7

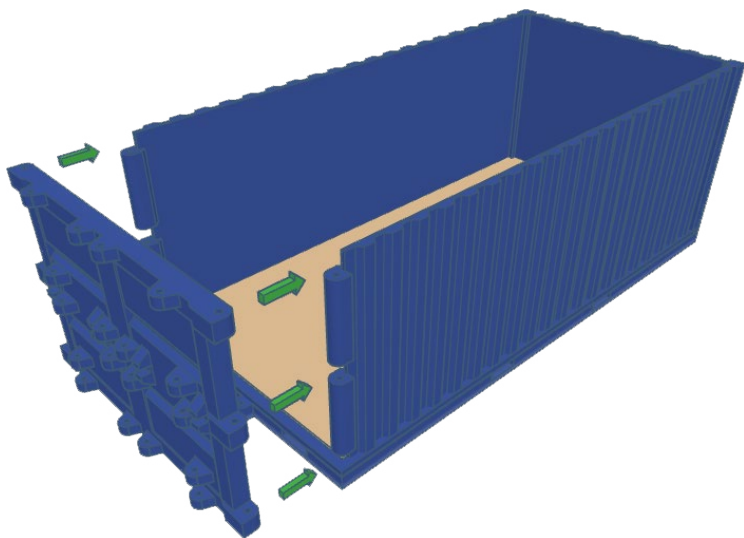

8



DOOR HINGE PINS

CUT TWO EQUAL 85MM PIECES OF SILVER FILAMENT USING CLIPPERS AND GENTLY STRAIGHTEN THEM OUT BY HAND.

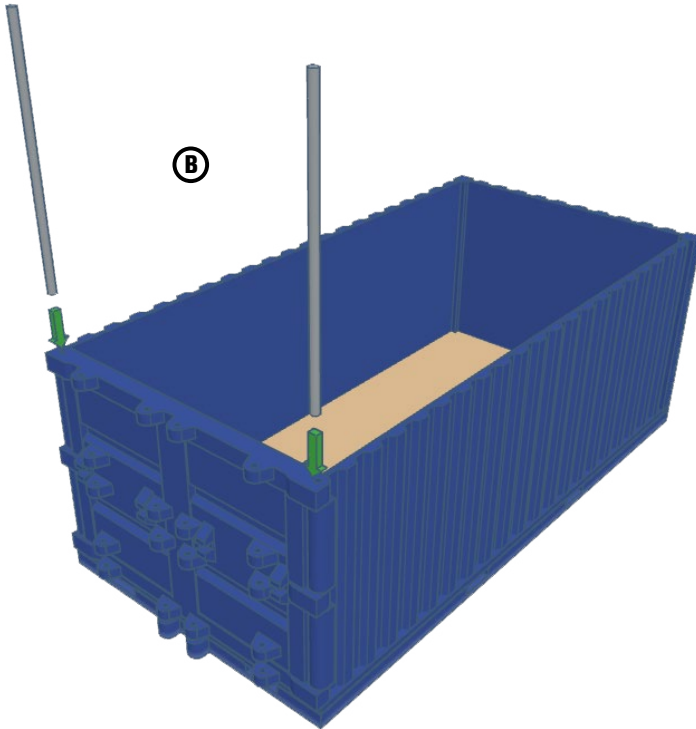
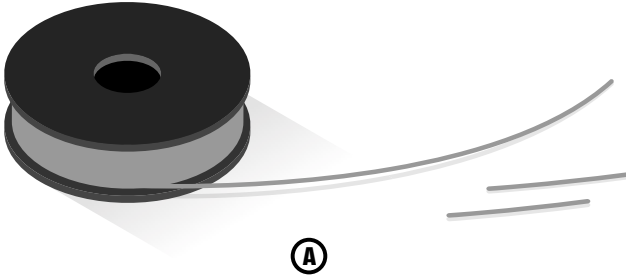

9



*5



CONTAINER-LG-ROOF.STL

165×80.5×5.25MM

3H 8M

36G

CONTAINERS ARE MAGNETICALLY ATTACHED TO OCTOCOPTER. PAUSE THE PRINTER AND PLACE MAGNETS INTO MAGNET ENCLOSURES BEFORE FINISHING THE ROOF PRINT.

A

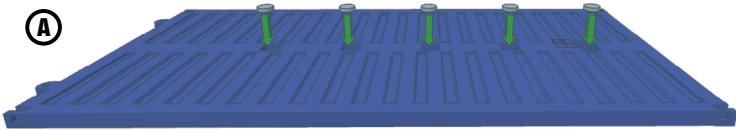

B

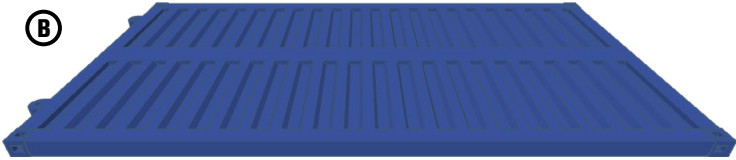

10



TO PREVENT DOORS FROM BEING GLUED IN-PLACE, BE SURE TO ONLY DEPOSIT GLUE ON THE WALLS OF THE CONTAINER, AVOIDING THE HINGES.

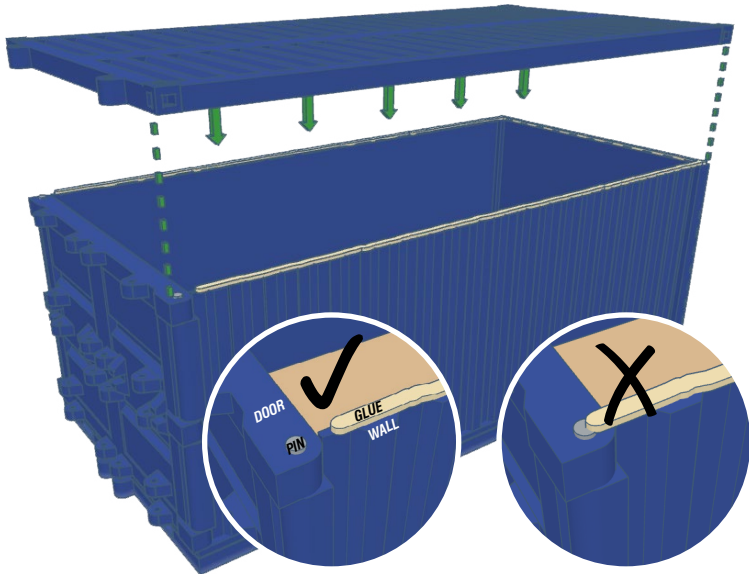

11



CONTAINER-LG-DOOR-LOCKS.STL

56.25×6×2MM

4M

0.25G



A

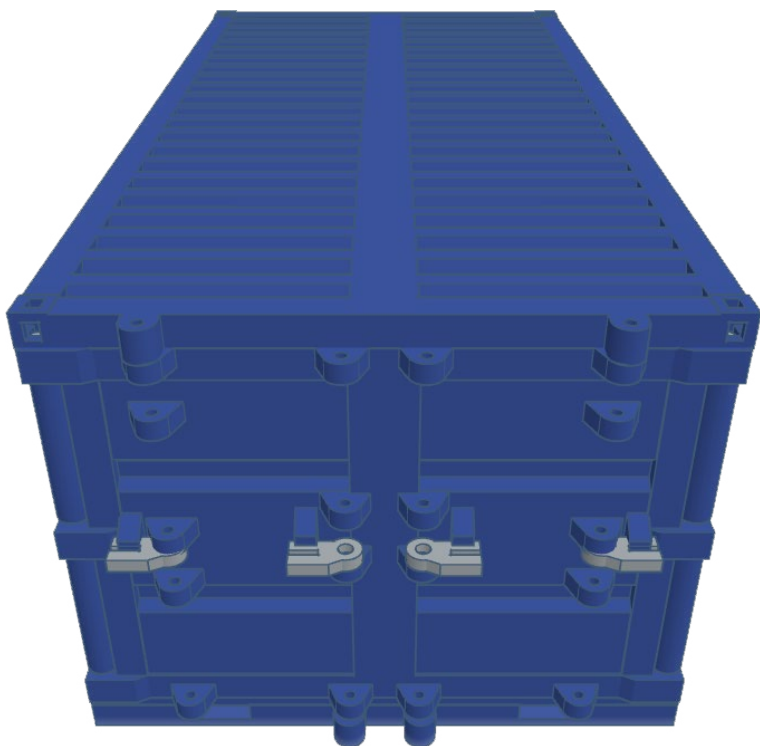

B



12



DOOR LOCK PINS

CUT FOUR EQUAL 59MM PIECES OF SILVER FILAMENT USING CLIPPERS AND STRAIGHTEN THEM OUT BY HAND.

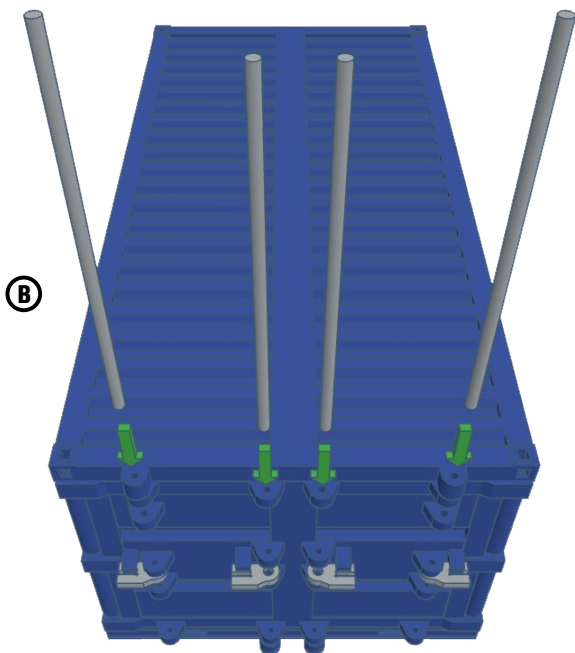
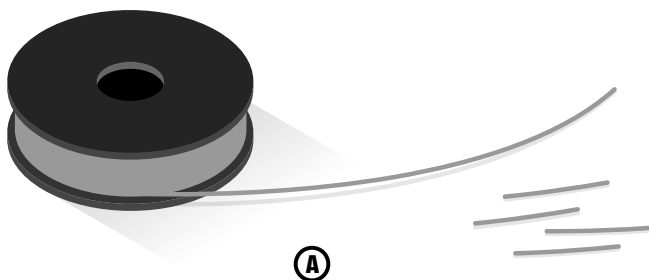

13



TAKE EXTRA CARE WHILE GLUING LOCK HANDLES TO LOCK PINS. ENSURE THAT THE PIN DOES NOT GET GLUED TO THE DOOR. USE ONLY A TINY DROP OF GLUE ON EACH HANDLE AS SHOWN BELOW.

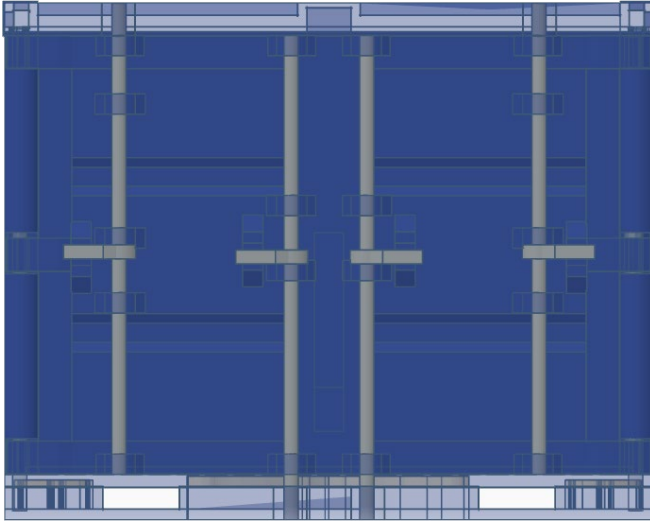

POSITION OF LOCK PINS

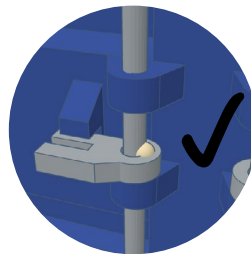

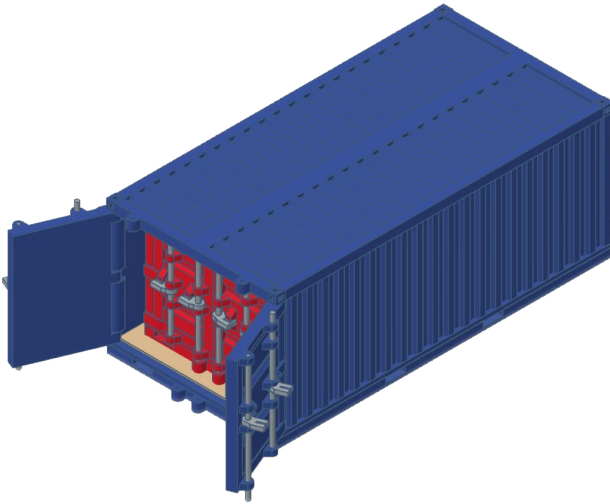
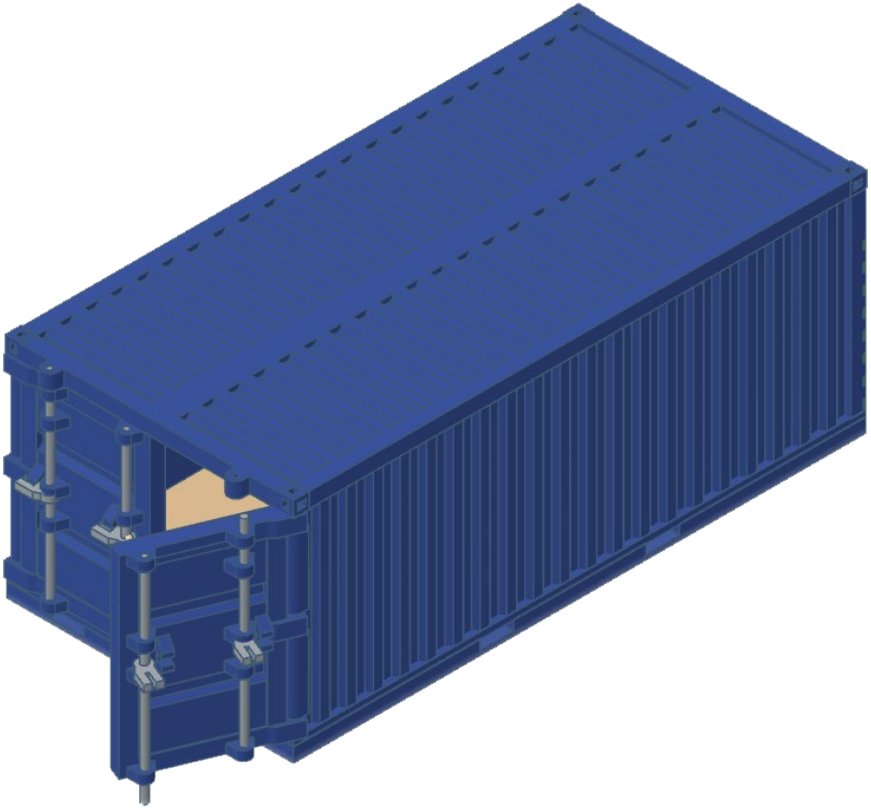

MPO-2 OCTOCOPTER

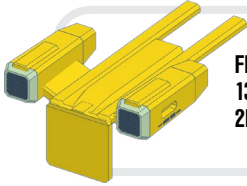

FRAME PAGES 4-13
13:37 PRINT TIME
2H BUILD TIME

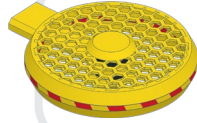

ROTORS PAGES 4-13
13:37 PRINT TIME
2H BUILD TIME

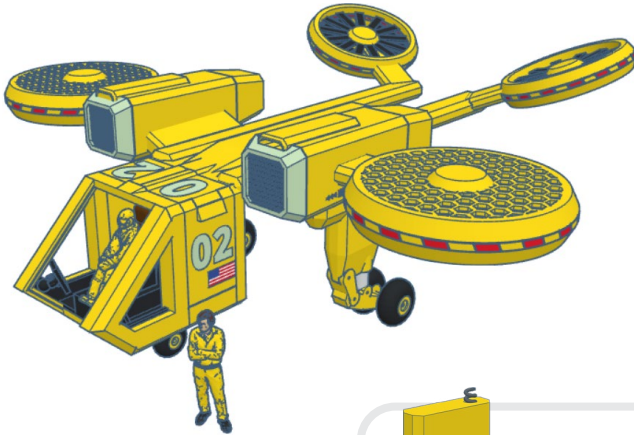

COCKPIT PAGES 4-13
13:37 PRINT TIME
2H BUILD TIME

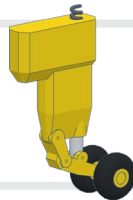

GEAR PAGES 4-13
13:37 PRINT TIME
2H BUILD TIME

FRAME

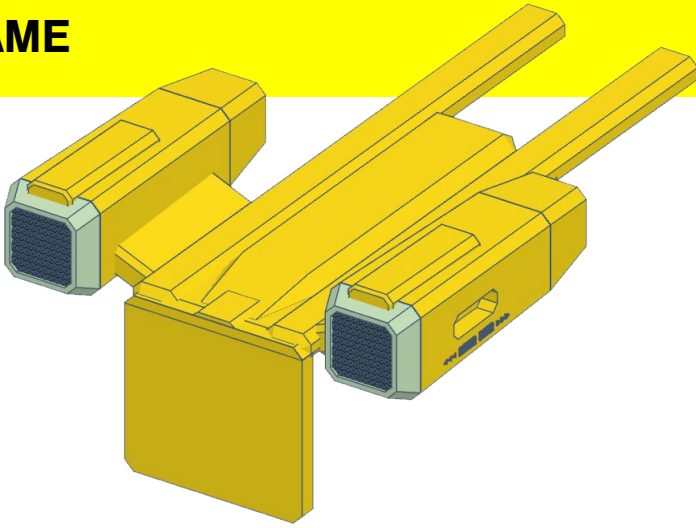

FILAMENT COLORS USED



CONSTRUCTION
YELLOW

BLACK

GLOW-IN-
THE-DARK

TOOLS & SUPPLIES NEEDED



CA GLUE

MAGNETS
~10

CLIPPERS

13



CONTAINER-LG-BASE-A.STL

164.76×80×5MM

2H 46M

32G



ROTORS

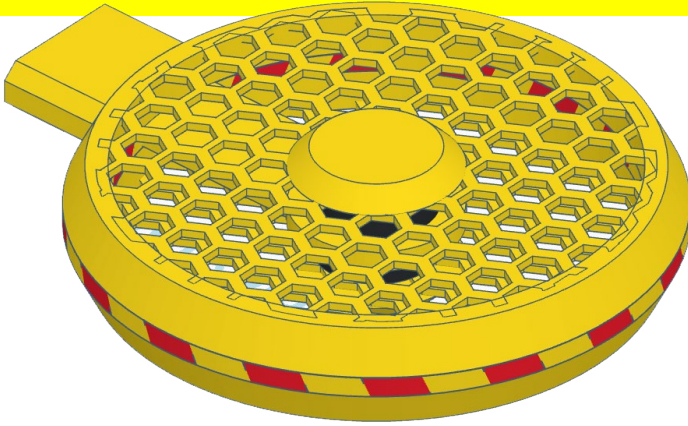

FILAMENT COLORS



CONSTRUCTION
YELLOW

BLACK

TOOLS & SUPPLIES



CA GLUE

CLIPPERS

13



CONTAINER-LG-BASE-A.STL

164.76×80×5MM

2H 46M

32G



COCKPIT

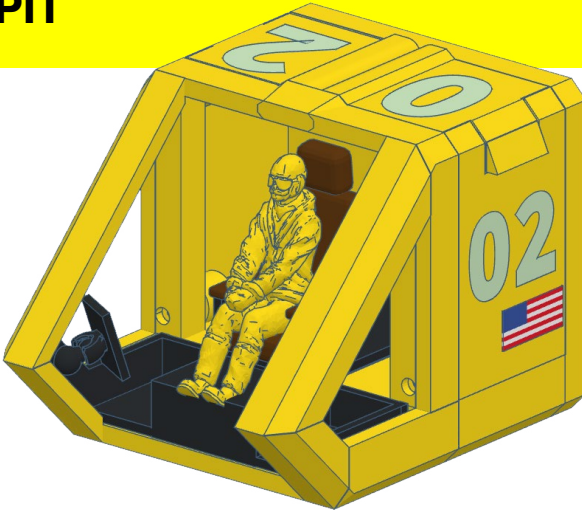

FILAMENT COLORS



CONSTRUCTION
YELLOW

BLACK

GLOW-IN-
THE-DARK

BLUE

RED

WHITE

DARK
BROWN

TOOLS & SUPPLIES



CA GLUE

MAGNETS
×13

CLIPPERS

13



CONTAINER-LG-BASE-A.STL

164.76×80×5MM

2H 46M

32G

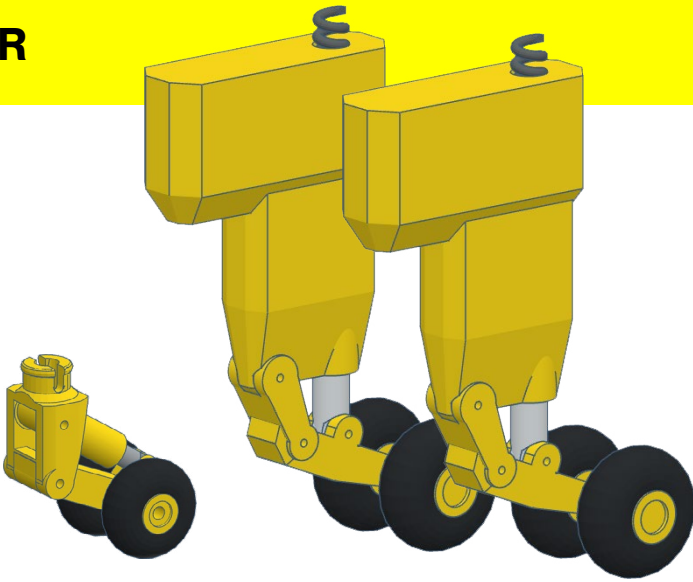

FILAMENT COLORS



BLUE

BLACK
FLEXIBLE

SILVER

TOOLS & SUPPLIES



CA GLUE

SPRINGS
×3

CLIPPERS

13



CONTAINER-LG-BASE-A.STL

164.76×80×5MM

2H 46M

32G



2H PRINT TIME



2H PRINT TIME



2H PRINT TIME

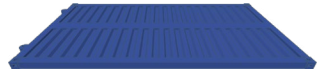

2H PRINT TIME

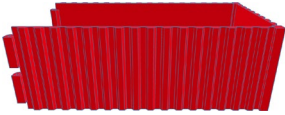

2H PRINT TIME

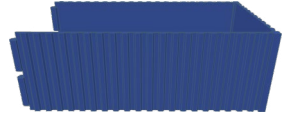

2H PRINT TIME



2H PRINT TIME



2H PRINT TIME



2H PRINT TIME



2H PRINT TIME

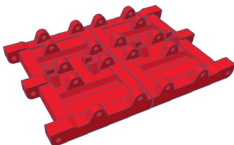

2H PRINT TIME

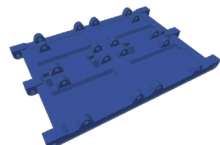

2H PRINT TIME

2H PRINT TIME

2H PRINT TIME

2H PRINT TIME

2H PRINT TIME

2H PRINT TIME

2H PRINT TIME

2H PRINT TIME

2H PRINT TIME

2H PRINT TIME

2H PRINT TIME

2H PRINT TIME

2H PRINT TIME



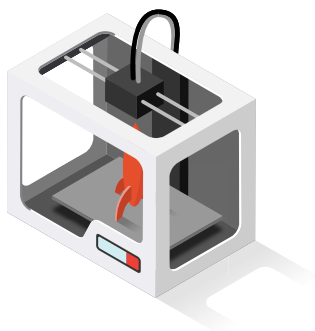

enjoy! :)



For more exciting projects visit
3dprintingstar.com